

# NORMACONNECT® EuroCoupler



**Pipe to pipe connection of an exhaust system without the need for sizing or slotting**

- ✓ Used as original equipment in vehicles of major European OE manufacturers.
- ✓ Patented gasket with proven sealing ability reduces leak rates.
- ✓ Inner sleeve orientation is locked by an engagement feature, improving sealing effect.
- ✓ A "U" slot helps EuroCoupler accommodate diameter differences between mating pipes for improved joint strength.



Air Intake & Induction



Exhaust Systems



Cooling Systems



Fuel & Oil Systems



Turbocharger Installations



Fixing & Retaining

## EXHAUST CLAMPS & COUPLINGS

### NORMACONNECT® EuroCoupler

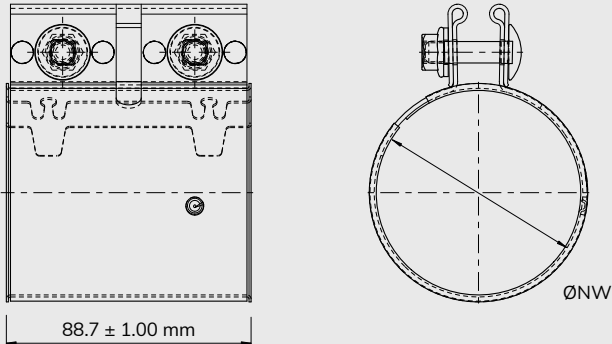

### Applications

The EuroCoupler is a lightweight connector for rear and centre section of car and truck exhaust systems.

### Material

Group	W3
Band	1.4509 / 441SS
Sleeve	1.4509 / 441SS
Bolt	Carbon Steel
Washer	Carbon Steel
Nut	Carbon Steel

Part number	Description	ØNW (mm)	Packaging quantity (pcs)
0367 6005 040	EUROCOUPLER 40-441/88	40	25
0367 6009 045	EUROCOUPLER 45-441/88	45	25
0367 6010 050	EUROCOUPLER 50-441/88	50	25
0367 6008 055	EUROCOUPLER 55-441/88	55	25
0367 6011 060	EUROCOUPLER 60-441/88	60	25
0367 6022 065	EUROCOUPLER 65-441/88	65	25
0367 6033 070	EUROCOUPLER 70-441/88	70	25

### Technical benefits

- ✓ Provides a serviceable joint – no permanent distortion of exhaust components.
- ✓ Preassembled unit – easy, reliable installation.
- ✓ Superior clamp load capability.

**NORMACONNECT® EuroCoupler is part of a broad portfolio.**  
Discover more!



SEC



ACCUSEAL

**PREMIER**  
**TecDoc®**  
**DATA SUPPLIER**



**Do you have questions or require a personal consultation?**

Feel free to contact our Automotive Aftermarket Team! Hotline +44 1635 574 005

Visit our website for more information about our Automotive Aftermarket products: [norma-aftermarket.com](https://norma-aftermarket.com)



**NORMA Group Holding GmbH | Edisonstraße 4 | 63477 Maintal | Germany | [norma-aftermarket.com](https://norma-aftermarket.com)**

This document supersedes all previous issues. No part of this publication may be reproduced without our prior written consent. In NORMA Group's policy of continual product improvements to meet user needs and technological developments, all models and sets listed in this folder (photographs, specifications, sizes and weights) may be upgraded or discontinued without notice and without any obligation on our part to modify tools or equipment sold previously. The recommendations for use and safety given in this folder do not replace accepted good practice or the safety related legal and regulatory provisions. References to standards implemented as of April 09, 2025 are not contractually binding.